

3 Way Tee Fittings

Completion Plug

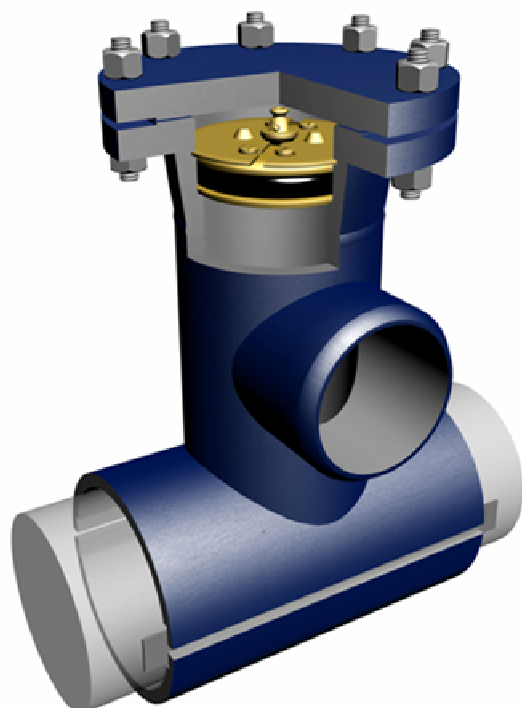
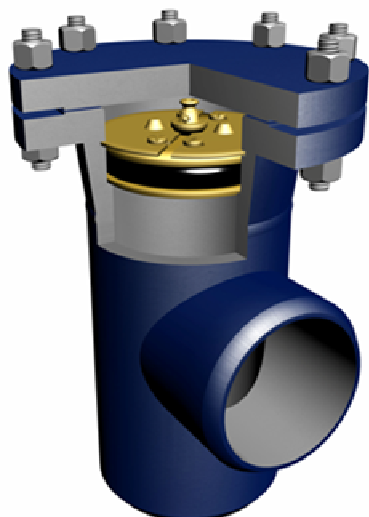

The **COMPLETION 3 WAY TEE** fittings are designed for main relocations, lateral connections, line extensions, equipment tie-ins, linestop operations, all without shutdown.

The **COMPLETION 3 WAY TEE** fittings are furnished with a blind flange with studs, nuts and gasket, an internal completion plug with O-ring and a flat bottom flanged nipple. They are available in sizes 4", 6", 8", 10", 12" Class 150 and Class 300. With a flange Class 150, the maximum operating pressure is 19 bar. With a flange class 300, the maximum operating pressure is 51 bar. The **COMPLETION 3 WAYTEE** fitting are designed to be used with the Hot-Tap equipment TBL-0322, TBL-0644 and TBL-1106. They allow to plug in different directions.

According to the size of the main pipe, the **COMPLETION 3 WAY TEE** fittings need an additional reinforcement like a **Weldolet or Pad**. The reinforcement is according to the client's specifications. When the **COMPLETION 3 WAY TEE** fitting has the same size than the main pipeline (size-on-size), the completion 3 way tee fitting needs a full encirclement reinforcement. In case there is no reinforcement needed, TECPESA also manufactures this fitting with a scarfed or flat bottom ending.

The **COMPLETION 3 WAY TEES** are also available with a reducing branch to be used as bypass fittings or to connect different pipeline sizes.

All fittings are stamped with a code number for material identification. Material certificates are included.

The quality control is according to the client's specifications. Radiography testing, Ultra Sonic test, Magnetic Particle examination, Hydrostatic Testing, Physical Testing are available.



We stay in line

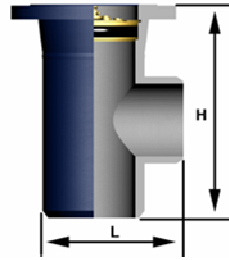

FLAT BOTTOM COMPLETION 3 WAY TEES

Size		Weight	H		L		Class 150	Class 300
inch	mm	kg	inch	mm	inch	mm	Stock Number	Stock Number
4	100	15	9,8	249	6,5	171	04.150.01.0000.01.02	04.300.01.0000.01.02
6	150	23	13,3	338	8,0	224	06.150.01.0000.01.02	06.300.01.0000.01.02
8	200	57	14,5	360	10,0	273	08.150.01.0000.01.02	08.300.01.0000.01.02
10	250	82	19,0	483	14,0	378	10.150.01.0000.01.02	10.300.01.0000.01.02
12	300	124	21,5	545	17,0	441	12.150.01.0000.01.02	12.300.01.0000.01.02

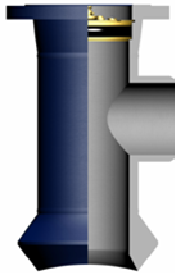

According to the client's specification, TECPESA can manufacture both types of reinforcement: **Weldolet (left) or Pad (right)**

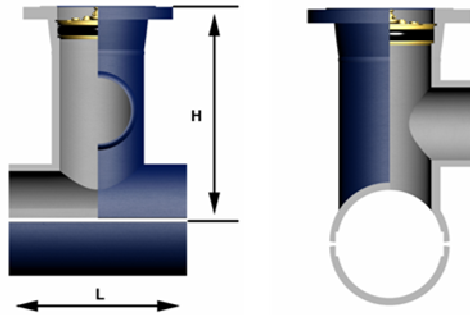
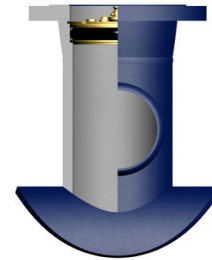

FULL ENCIRCLEMENT COMPLETION 3 WAY TEE

Size		Weight	H		L		Class 150	Class 300
inches	mm	Kg.	inches	mm	inches	mm	Stock Number	Stock Number
4	100	41,5	13	343	11	273	04.150.01.0204.01.02	04.300.01.0204.01.02
6	150	82,5	19	488	14	356	06.150.01.0206.01.02	06.300.01.0206.01.02
8	200	134,0	23	600	16	419	08.150.01.0208.01.02	08.300.01.0208.01.02
10	250	215,0	28	711	20	508	10.150.01.0210.01.02	10.300.01.0210.01.02
12	300	317,0	32	830	22	559	12.150.01.0212.01.02	12.300.01.0212.01.02

The figures indicated on the chart above may change
 All details of the spare parts (O-ring, internal plug, etc...) are available in the Bulletin Number: 2009.200.00

TECPESA, S.A.

Balmes 129 Bis, 1º, 1ª - 08008 Barcelona - Spain
 Tel: +34 934 510 760 Fax: +34 934 510 793

sales@tecpesa.com
 www.tecpesa.com